

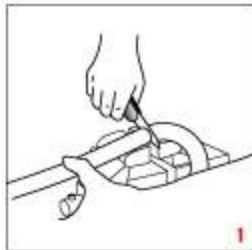

Super Stock™ Hose Ends with Super Stock Hose Assembly Instruction



1. Cut the hose square with a sharp knife.



2. Slip the aluminum collar over the hose.



3. Mark the hose at the back of the collar.

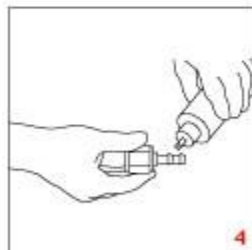

4. Lubricate the inside of the hose and the outside of the nipple. Use assembly lube or engine oil. Do not use a silicon-based lube.

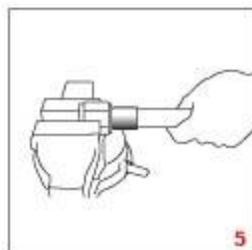

5. Push the hose end into the hose until it bottoms.

6. Check the mark made on the hose in Step 3 to ensure that the hose end has indeed bottomed against the end of the hose.

7. Blow the assembly clean and pressure test before running the car.



Pressure Test All Hose Assemblies Before Installation!