

# MPS Solenoid Rebuilt Kit

(P/N 1-0513)

This pack consists of critical components necessary to bring solenoids back into service quickly and conveniently. The life of our quality solenoids can be extended economically and effectively in this manner.

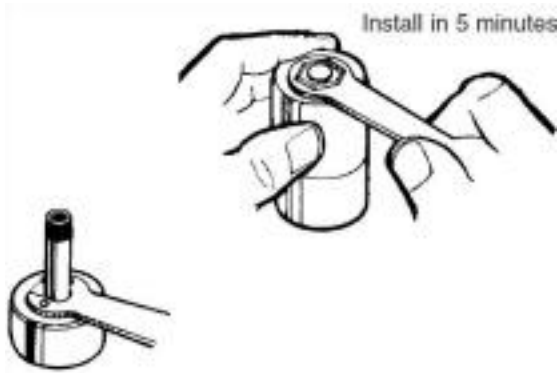

## Directions:

With the wrench supplied remove top nut and housing. Using the same wrench remove sleeve assembly plunger, spring and seal. Discard all these items. Do not re-use any portion of this group.

Be sure to remove any foreign matter that might have accumulated inside the valve. A small swab is ideal for this purpose.

Insert new components supplied. The re-assembled solenoid is ready for service. This simple operation brings the valve to the original performance level.